

SKI FRONT VIEW 7-D
(SCALE: 1-1/2" = 1')

SKI FRONT VIEW 5-D
(SCALE: 1-1/2" = 1')

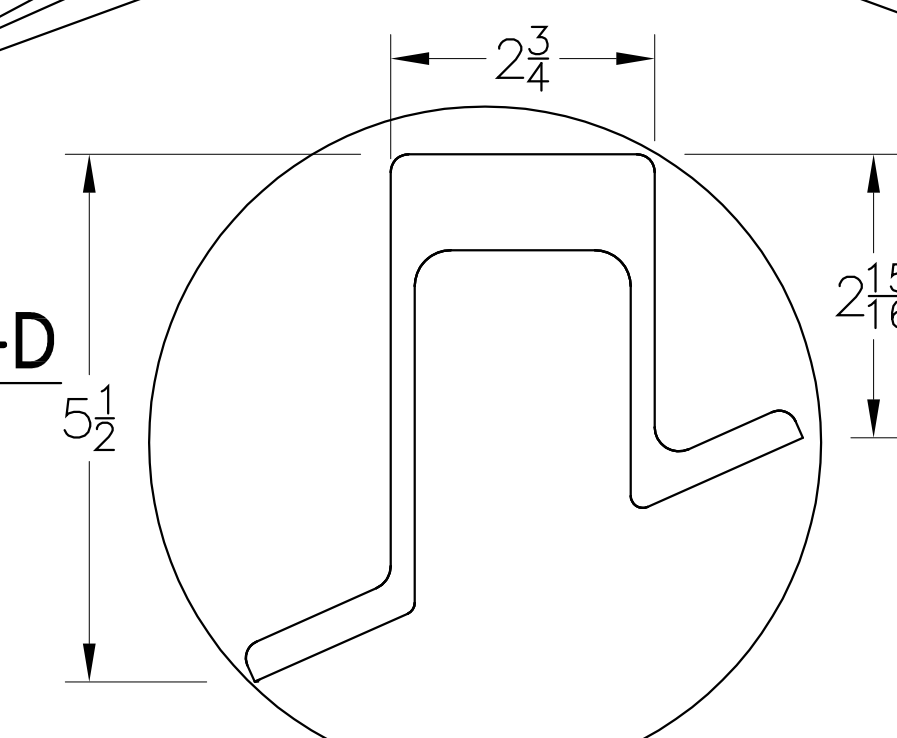

EXTRUSION FRONT VIEW 6-C
(SCALE: 1" = 2')

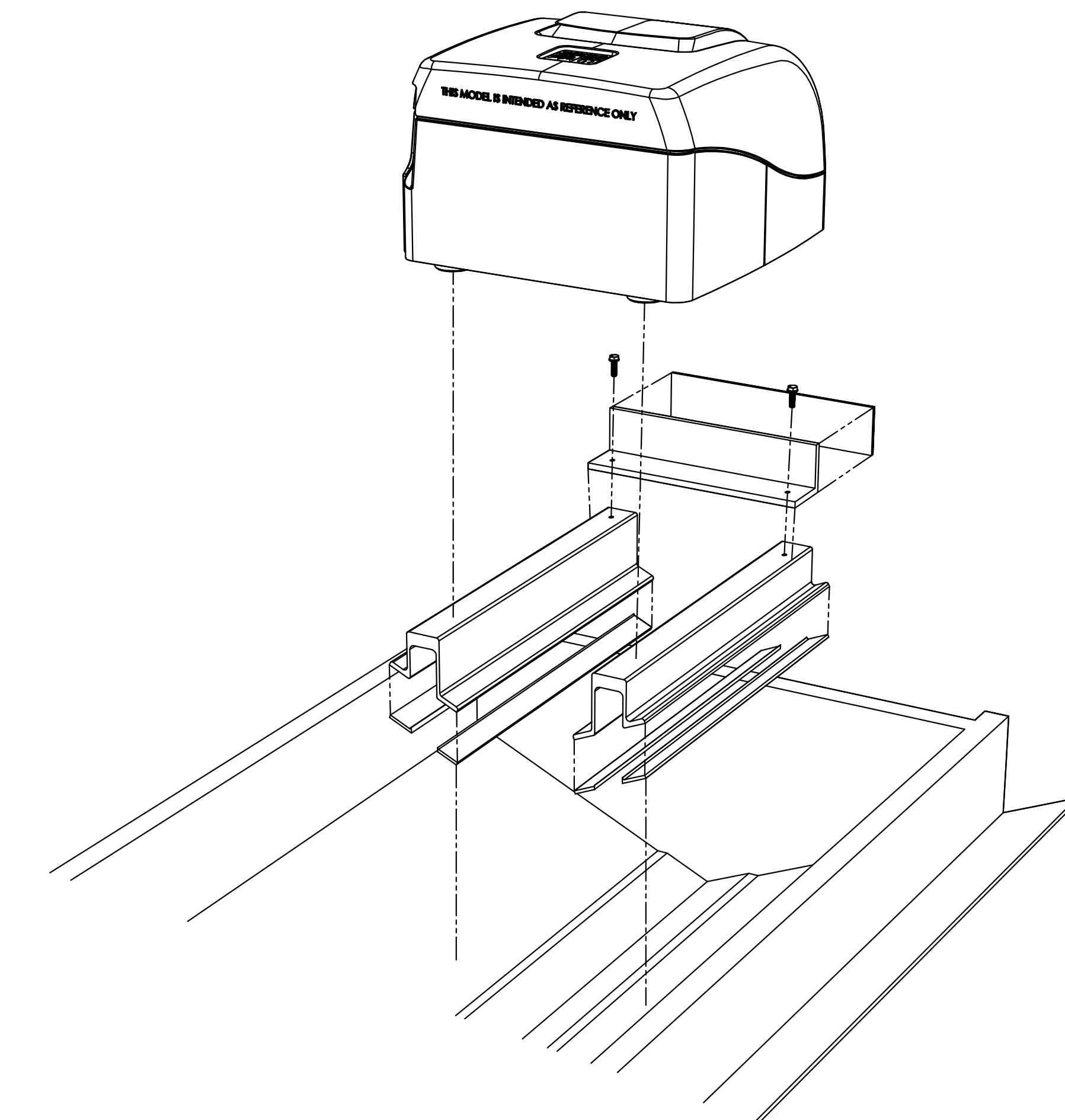

SKI ISO EXPLODED VIEW 2-C

NOTES:

- 1) DEADRISE CAN VARY FROM 20-28 DEGREES
- 2) STRINGERS SPACING MUST BE BETWEEN 31" AND 40"
- 3) LONGITUDINAL SUPPORTS TO BE GLUED TO HULL BOTTOM USING SCIGRIP SG300 WITH MINIMUM BOND THICKNESS OF 0.125" AND MAX BOND THICKNESS OF 0.5"
- 4) BULKHEAD CONNECTOR TO BE BOLTED TO LONGITUDINAL SUPPORTS AND GLUED TO STRUCTURAL BULKHEAD USING SCIGRIP SG300 WITH A MINIMUM BOND THICKNESS OF 0.125" AND MAX BOND THICKNESS OF 0.5"
- 5) MINIMUM HULL LAMINATION REQUIREMENT: 3 OZ CSM, 3 X E-WMV 2415. NOTE THAT THE LAMINATE THICKNESS, STRENGTH, AND STIFFNESS MUST BE EQUAL TO OR GREATER THAN THE LAMINATES SUGGESTED
- 6) MINIMUM STRINGER LAMINATION OUTLINED IN 6.1 AND 6.2 -- NOTE THAT THE LAMINATE THICKNESS, STRENGTH, AND STIFFNESS MUST BE EQUAL TO OR GREATER THAN EITHER OF THE LAMINATES SUGGESTED
 - 6.1) 3 X 3 OZ CSM
 - 6.2) 2 X E-LTM 2408
- 7) MINIMUM STRINGER HEIGHT IS 5.5" MEASURED FROM THE STRINGER CAP TO THE HULL BOTTOM INNER SKIN.
- 8) STRINGER WIDTH SHALL BE 1" MINIMUM
- 9) IF CORED, THE STRINGER ULTIMATE SHEAR STRESS X CORE THICKNESS NEEDS TO BE GREATER THAN 355 LBS/IN
- 10) STRINGER ATTACHMENT TO HULL BOTTOM IS ASSUMED TO BE ROBUST WITH LAMINATE LAPS AND FILLETS TO MINIMIZE STRESS
- 11) IF STRINGERS ARE MADE OF WOOD, MINIMUM THICKNESS IS 0.75" AND THEY MUST BE REINFORCED WITH THE MINIMUM LAMINATE AS DESCRIBED IN NOTE 6.
- 12) MAXIMUM DISTANCE FROM BULKHEAD IS 5", TOTAL MAX PANEL LENGTH IS 72"
- 13) INSTALLATIONS OUTSIDE OF THE RECOMMENDED REQUIREMENTS ARE NOT WITHIN DESIGN GUIDELINES AND NEED TO BE ANALYZED ON A CASE BY CASE BASIS.

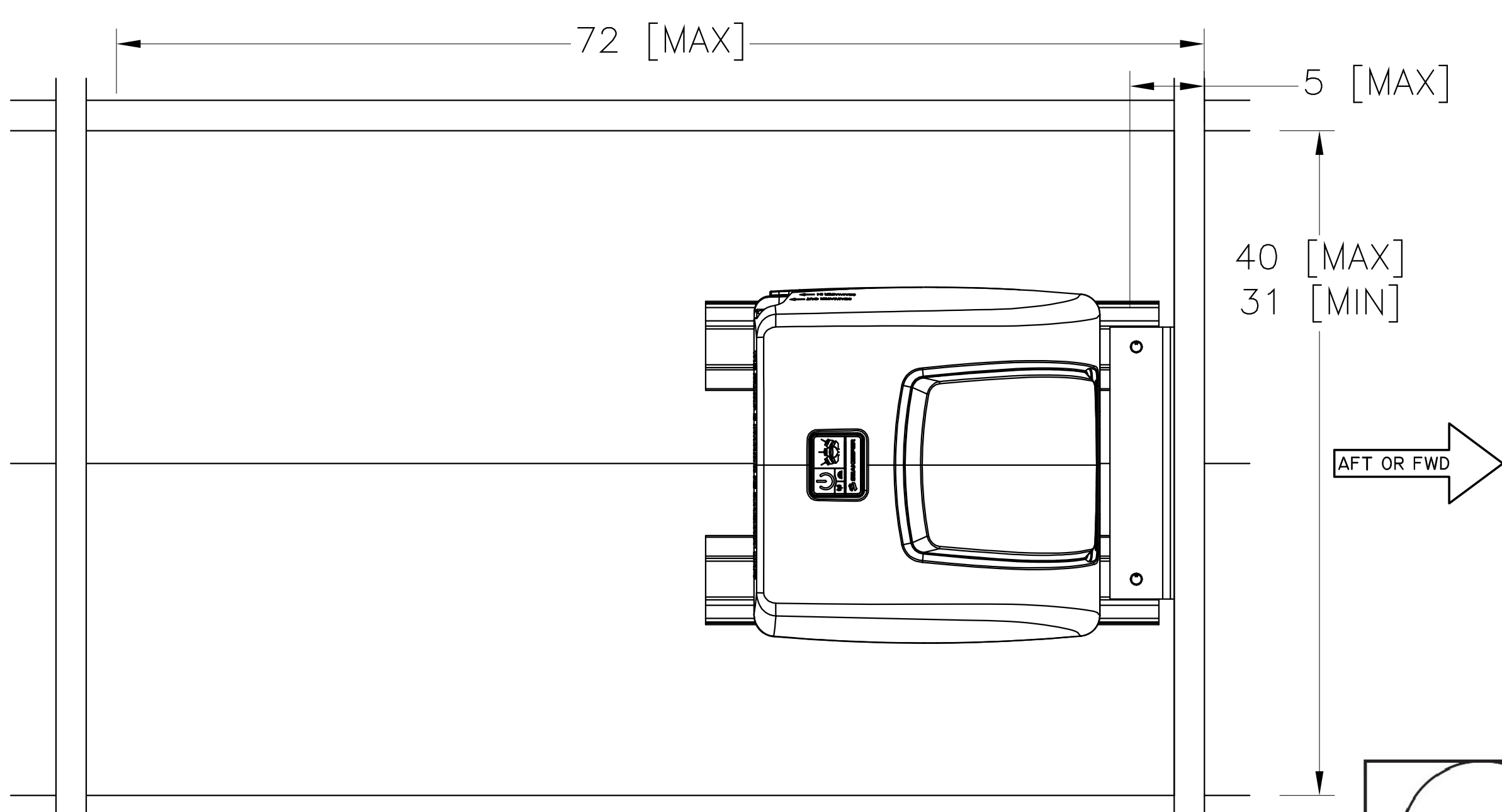

SKI TOP VIEW 2-B
(SCALE: 1-1/2" = 1')



TORX MARINE ©2020

| REV | ZONE | DESCRIPTION | DATE | APPROVED |
|-----------|------|-----------------------------|------------|----------|
| C | ALL | ADHESIVE SPEC SCIGRIP SG300 | 12/08/2020 | JHC |
| REVISIONS | | | | |

| | | | | | |
|--|--|------------------------------------|----------------------|---|--------------------------------|
| PREPARED FOR TRI SEA STABILIZERS | VESSEL / PROJECT TORX TUBE 1 | CUSTOMER APPROVED BY T. NICHOLS | DATE 12/09/2020 | SIZE D | CUSTOMER TORX TUBE |
| 2200 MARINA BAY DRIVE E. FT. LAUDERDALE, FL 33312 TEL: +1 (954) 384-0100 EMAIL: INFO@TRISEAKEEPER.COM | | CHECKED JHC | DATE 12/09/2020 | DESCRIPTION TORX APPLICABILITY RANGE AND INSTALLATION | ESWS 600 |
| CAGE CODE | | APPROVED | DATE | ESWS 600 | DWG NO. TTC1-600-130 |
| SOLICITATION NUMBER | | SCALE 1-1/2" = 1" | MASS (WEIGHT) LBS | DATE 12/09/2020 | REV C |
| | | | | SHEET 1/1 | |

DWG NO. TTC1-600-130
 REV SHEET 1/1
 ESWS 600